

ADS 2/2-way solenoid valve of stainless steel 316 body for slight acid & alkali-resistant application

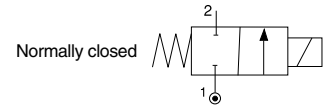

Direct-operated Type

Model	Port size	Orifice (mm)	CV value	Fluid temp. (°C)	Seat disc	Differential pressure kg/cm ² (bar)					Wt. (kg)
						Liquid	Air	Gas	slight acid & alkali	Vacuum	
ADS - 8A	1/4 "	3	0.26	-10	NBR	0-10	0-10	0-10	0-10	0-10 ⁻⁶ torr	0.47
ADS - 8B	1/4 "	4	0.58			0-7	0-7	0-7	0-7	0-10 ⁻⁶ torr	0.47
ADS - 8C	1/4 "	5	0.64			0-5	0-5	0-5	0-5	0-10 ⁻⁶ torr	0.47
ADS - 10A	3/8 "	4	0.58	∫	EPDM	0-10	0-10	0-10	0-10	0-10 ⁻⁶ torr	0.73
ADS - 10B	3/8 "	6	0.79			0-5	0-5	0-5	0-5	0-10 ⁻⁶ torr	0.73
ADS - 10C	3/8 "	8	0.97			0-2	0-2	0-2	0-2	0-10 ⁻⁶ torr	0.73
ADS - 12A	1/2 "	6	0.79	120	PTFE	0-5	0-5	0-5	0-5	0-10 ⁻⁶ torr	0.78
ADS - 12B	1/2 "	8	0.97			0-2	0-2	0-2	0-2	0-10 ⁻⁶ torr	0.78

How to order

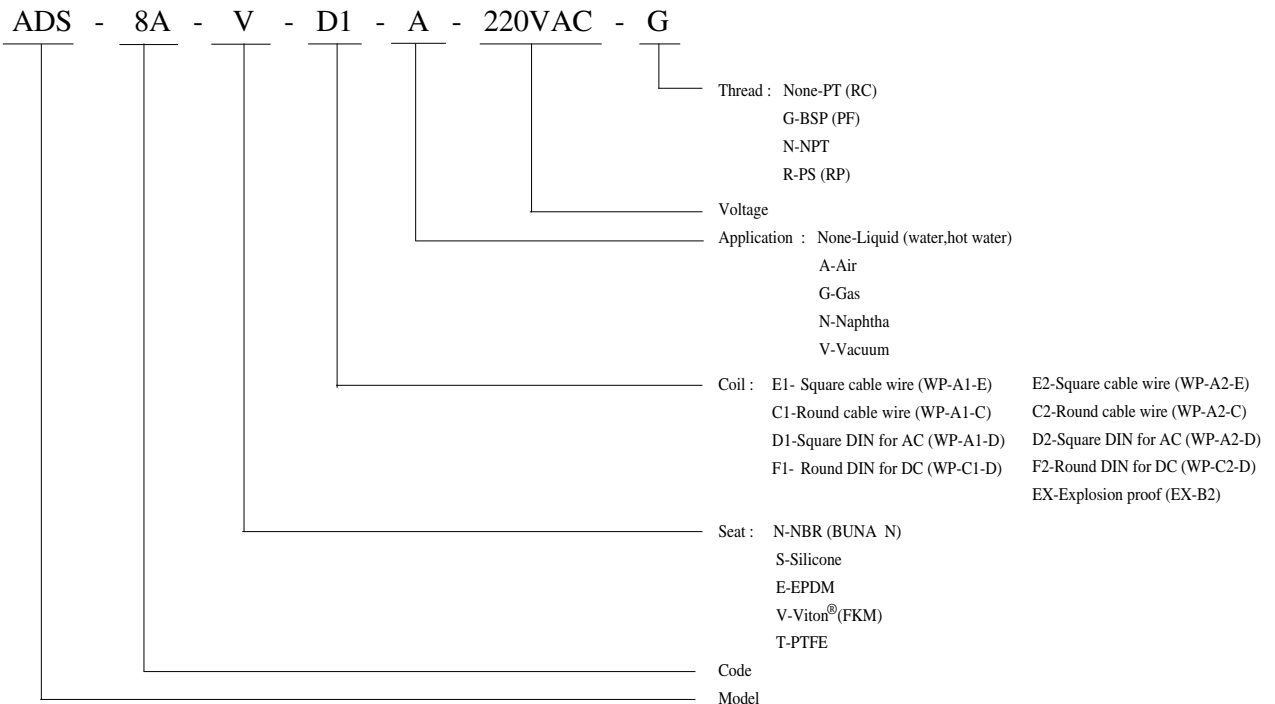

Notes:

1. Direct-acting valves are ideally suited to allocate at any angle.
2. Voltage drop range is within ±10%.
3. Pressure of voltage DC is 70% of voltage AC only.
4. Max. temperature is up to 120°C.
5. Selection of coil refer to page 136~139.
6. Silver shading ring is custom-made.

Inapplicable Fluids:

1. Fluids that have kinematic viscosity over 50 CST.
2. Fluids that will turn to liquid after being heated and become solid after being cooled.
3. Strong corrosive fluids.

ADS 2/2-way solenoid valve of stainless steel 316

body for slight acid & alkali-resistant application

● ADS-8A~12B Contour Specification Chart

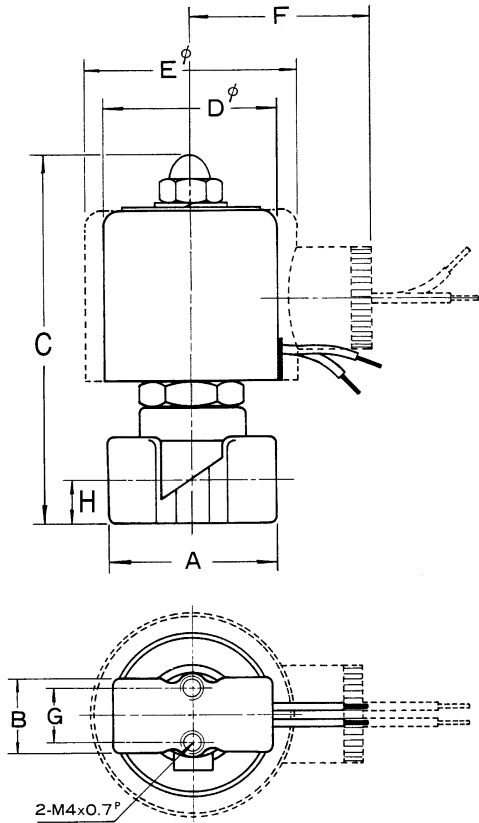

● Specifications

Unit:mm

Item Model	A	B	C	D	E	F	G	H	Coil Model
ADS-8A~8C	41	19	89	41.5	--	22	15	10.5	WP-A1-C
	41	19	85	53	--	63	15	10.5	WP-A1-D*
	41	19	85	58	--	33	15	10.5	WP-A1-E
	41	19	86	56	--	64	15	10.5	WP-C1-D*
ADS-10A-10C	50	25	93	--	53	47	15	11.7	WP-A2-C
	50	25	90	--	58	65	15	11.7	WP-A2-D*
	50	25	90	--	63	40	15	11.7	WP-A2-E
	50	25	90	--	68	70	15	11.7	WP-C2-D*
ADS-12A-12B	55	27	91	--	53	47	--	13	WP-A2-C
	55	27	91	--	58	65	--	13	WP-A2-D*
	55	27	91	--	63	40	--	13	WP-A2-C
	55	27	91	--	68	70	--	13	WP-C2-D*

* with connector

● ADS-8A~12B Operation Chart

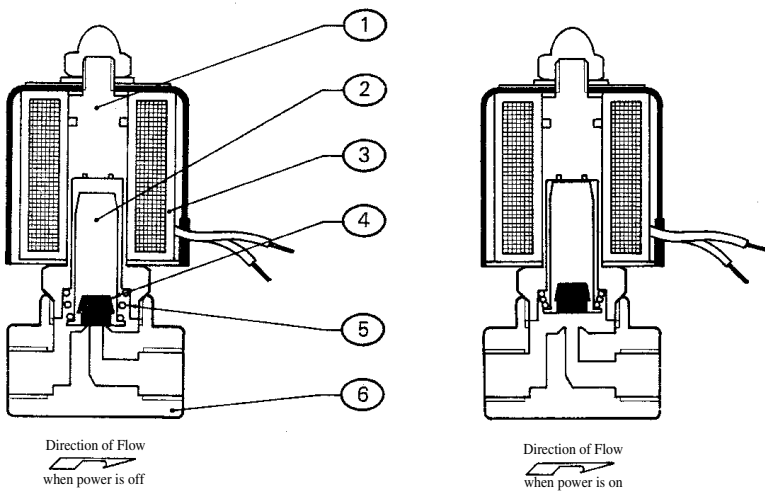

● ADS-8A~12B Material Table

Item	Article	Material
1	Solenoid Tube	Stainless Steel
2	Armature Core	Stainless Steel
3	Coil	Brass Wire
4	Seat	NBR, Silicone, Viton®, EPDM, PTFE
5	Spring	Stainless Steel
6	Valve Body	Stainless Steel(SUS 316)

ADS 2/2-way solenoid valve of stainless steel 316 body for slight acid & alkali-resistant application

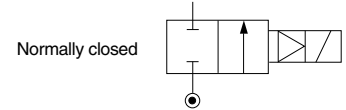

Magnalift Type

Model	Port size	Orifice (mm)	CV value	Fluid temp. (°C)	Seat disc	Differential pressure kg/cm ² (bar)					Wt. (kg)		
						Liquid	Air	Gas	Slight acid & alkali	Vacuum			
ADS - 14	3/8 "	15	4.5	-10	NBR	0-10	0-10	0-10	0-10	0-10 ⁻⁶ torr	1.03		
ADS - 15	1/2 "	15	4.5			0-10	0-10	0-10	0-10	0-10 ⁻⁶ torr	1.06		
ADS - 20	3/4 "	20	9.3			0-10	0-10	0-10	0-10	0-10 ⁻⁶ torr	1.24		
ADS - 25	1 "	25	13.2			0-10	0-10	0-10	0-10	0-10 ⁻⁶ torr	1.51		
ADS - 35	1 1/4 "	35	26			Silicone	0-10	0-10	0-10	0-10	0-10 ⁻⁶ torr	2.87	
ADS - 40	1 1/2 "	35	26				0-10	0-10	0-10	0-10	0-10 ⁻⁶ torr	2.77	
ADS - 50	2 "	50	48				EPDM	0-7	0-7	0-7	0-5	0-10 ⁻⁶ torr	4.81
ADS-25AF	1" Flange	25	13.2					0-10	0-10	0-10	0-10	0-10 ⁻⁶ torr	5.35
ADS-35AF	1 1/4" Flange	35	26			Viton®	0-10	0-10	0-10	0-10	0-10 ⁻⁶ torr	7.75	
ADS-40AF	1 1/2" Flange	35	26				0-10	0-10	0-10	0-10	0-10 ⁻⁶ torr	7.8	
ADS-50AF	2" Flange	50	48	0-7	0-7		0-7	0-5	0-10 ⁻⁶ torr	11.0			

How to order

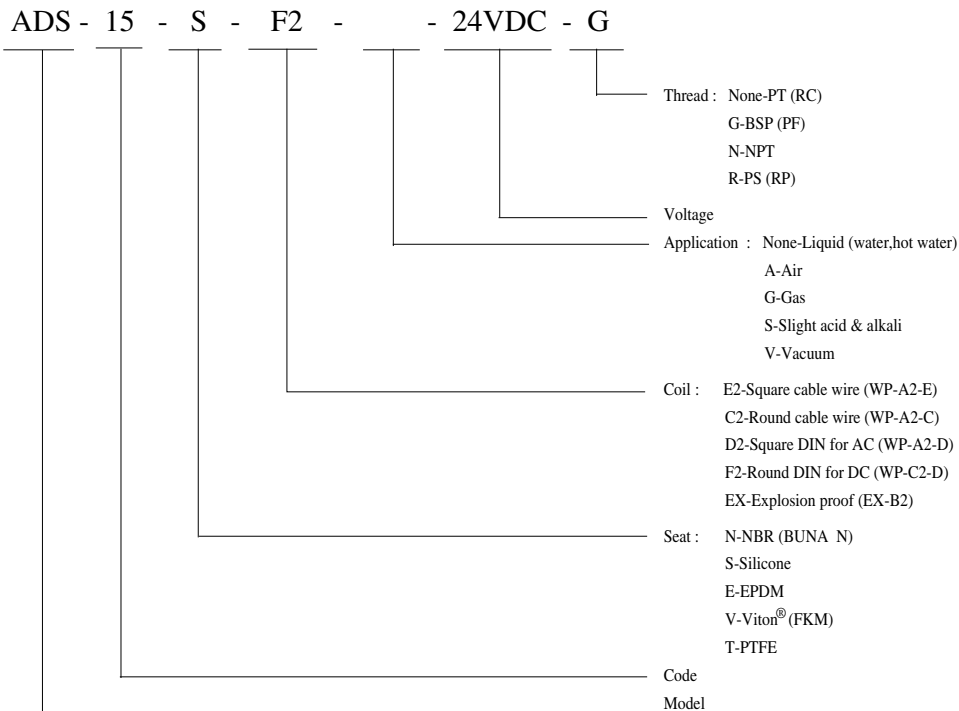

Notes:

- In order to prolong operating life, it is better to allocate pipe horizontally and coil to face upward.
- Voltage drop range is within ±10%.
- Pressure of voltage DC is 70% of voltage AC only.
- Combined diaphragm design assures no breaking.
- Max. temperature is up to 120°C.
- Selection of coil refer to page 136~139.
- PTFE diaphragm is custom-made.
- Silver shading ring is custom-made.

Inapplicable Fluids:

- Fluids that have kinematic viscosity over 50 CST.
- Fluids that will turn to liquid after being heated and become solid after being cooled.
- Strong corrosive fluids.

ADS

2/2-way solenoid valve of stainless steel 316 body for slight acid & alkali-resistant application

● ADS-14~50 Contour Specification Chart

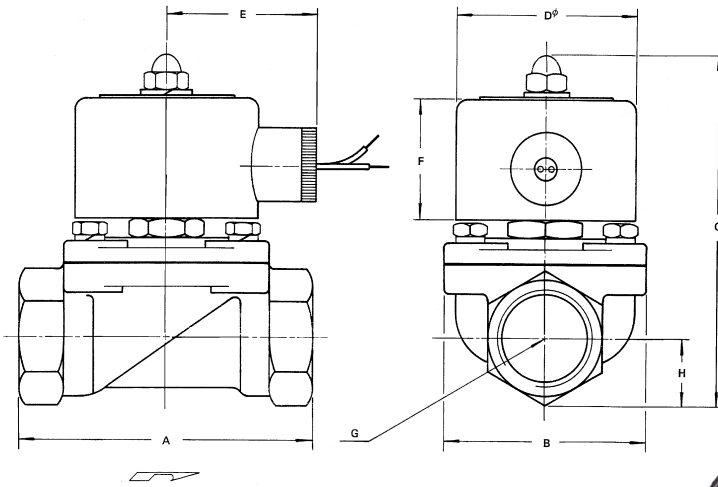

● Specifications

Unit:mm

Item	A	B	C	D	E	F	G	H
Model								
ADS-14	75	52	103				3/8"	14.5
ADS-15	75	52	103	WP-A2-C:53	WP-A2-C:47	WP-A2-C:43	1/2"	14.5
ADS-20	85	60	114	WP-A2-D:40	WP-A2-D:65*	WP-A2-D:38	3/4"	18
ADS-25	100	70	120				1"	23
ADS-35	120	90	140	WP-A2-E:40	WP-A2-E:40	WP-A2-E:38	1 1/4"	33
ADS-40	120	90	140	WP-C2-D:56	WP-C2-D:70*	WP-C2-D:37	1 1/2"	33
ADS-50	150	120	160				2"	40.5

* with connector

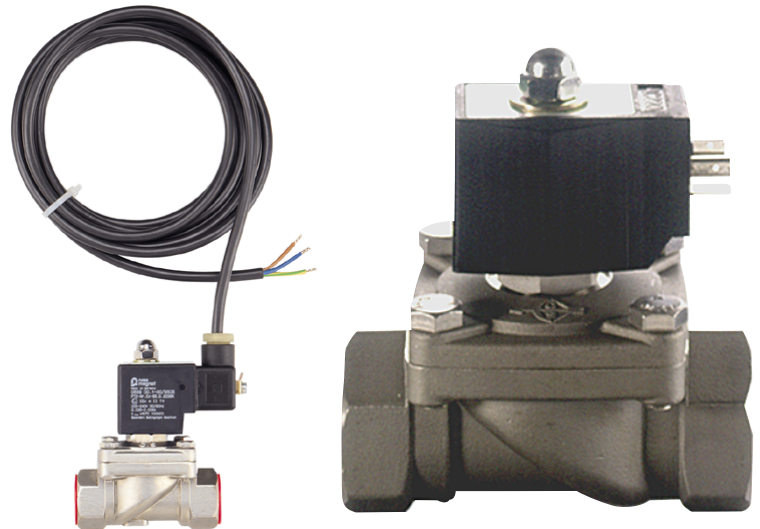

● ADS-14~50 Operation Chart

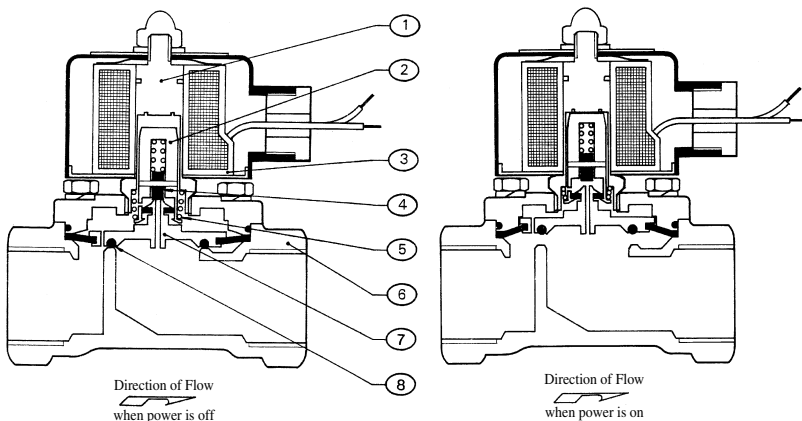

● ADS-14~50 Material Table

Item	Article	Material
1	Solenoid Tube	Stainless Steel
2	Armature Core	Stainless Steel
3	Coil	Brass Wire
4	Seat	NBR, Silicone, EPDM, Viton®
5	Spring	Stainless Steel
6	Valve Body	Stainless Steel (SUS 316)
7	Diaphragm	Stainless Steel/Synthetic Rubber
8	Leakproof Ring	Synthetic Rubber

ADS 2/2-way solenoid valve of stainless steel 316 body for slight acid & alkali-resistant application

● ADS-25AF~50AF Contour Specification Chart

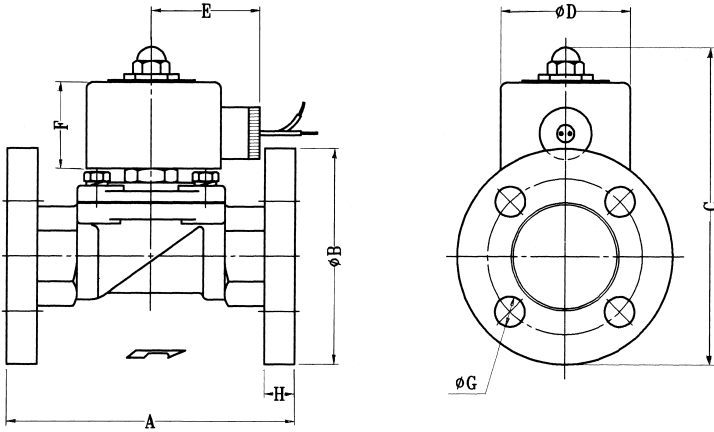

● Specifications

Item	A	B	C	D	E	F	G	H
Model								
ADS-25AF	140	125	162	WP-A2-C:53	WP-A2-C:47	WP-A2-C:43	19	14
ADS-40AF	165	140	177	WP-A2-D:40	WP-A2-D:65*	WP-A2-D:38	19	16
				WP-A2-E:40	WP-A2-E:40	WP-A2-E:38		
ADS-50AF	200	155	195	WP-C2-D:56	WP-C2-D:70*	WP-C2-D:37	19	16

(*with connector) JIS Flange Specification 10kg/cm²

● ADS-25AF~50AF Operation Chart

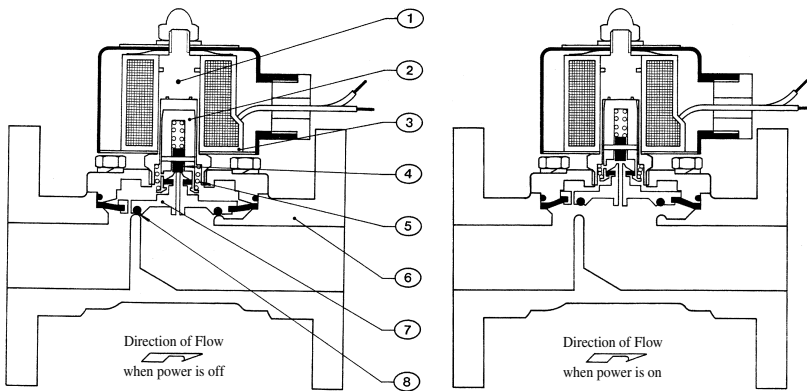
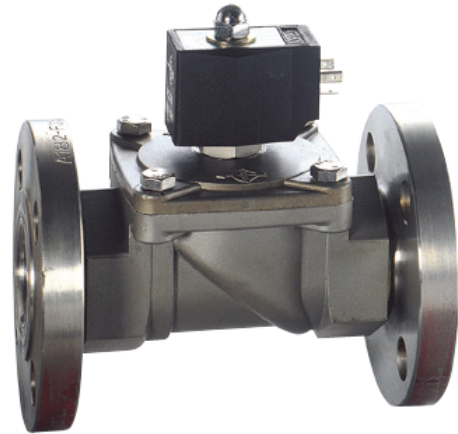

● ADS-25AF~50AF Material Table

Item	Article	Material
1	Solenoid Tube	Stainless Steel
2	Armature Core	Stainless Steel
3	Coil	Brass Wire
4	Seat	NBR, Silicone, EPDM, Viton®
5	Spring	Stainless Steel
6	Valve Body	Stainless Steel (SUS 316)
7	Diaphragm	Stainless Steel/Synthetic Rubber
8	Leakproof Ring	Synthetic Rubber



2/2-way solenoid valve of stainless stell 316 body for slight acid & alkali-resistant application

Flow Curve Chart

● Fluid:Air ADS-8A

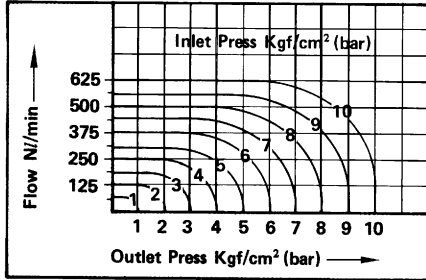

● Fluid:Air ADS-8B

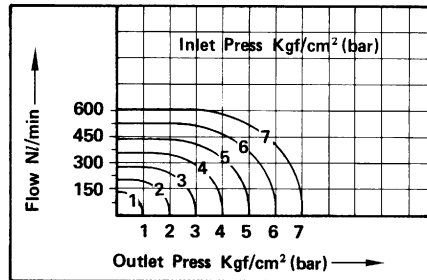

● Fluid:Air ADS-8C

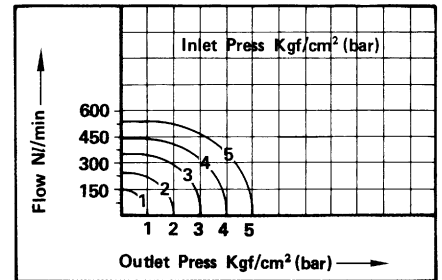

● Fluid:Air ADS-10A

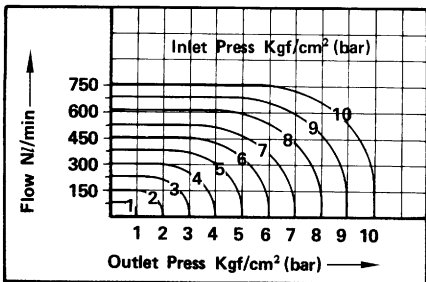

● Fluid:Air ADS-10B . 12A

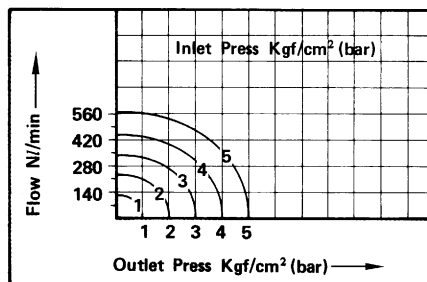

● Fluid:Air ADS-10C . 12B

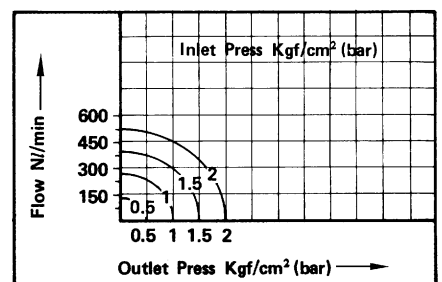

● Fluid:Air ADS-14.15

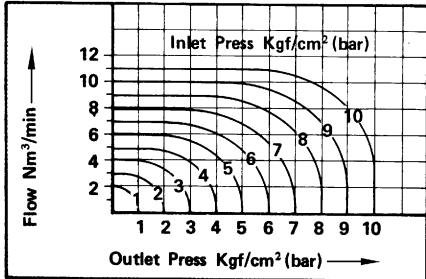

● Fluid:Air ADS-20

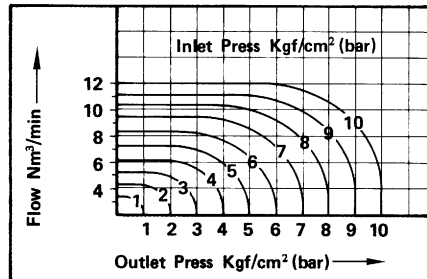

● Fluid:Air ADS-25 (AF)

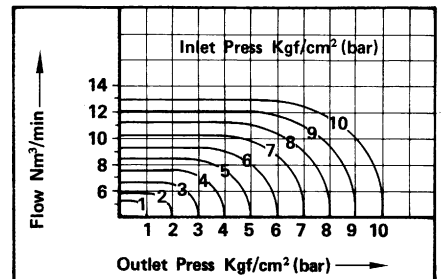

● Fluid:Air ADS-35.40(AF)

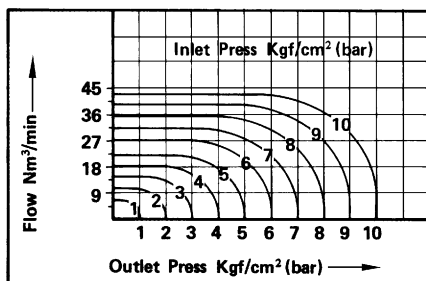

● Fluid:Air ADS-50(AF)

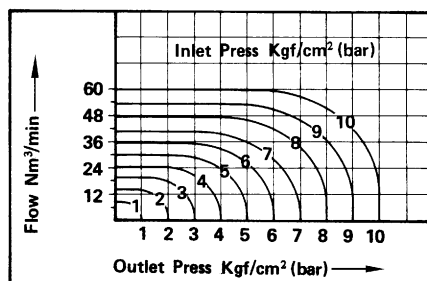

● Fluid:Liquid ADS-8A.8B.8C.

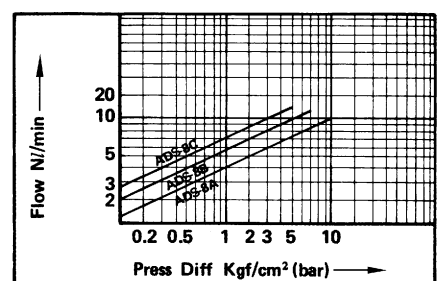

● Fluid:Liquid ADS-10A .10B.10C

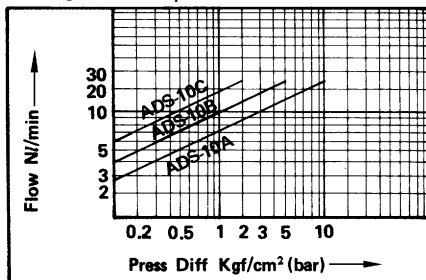

● Fluid:Liquid ADS-15.20.25 (AF)

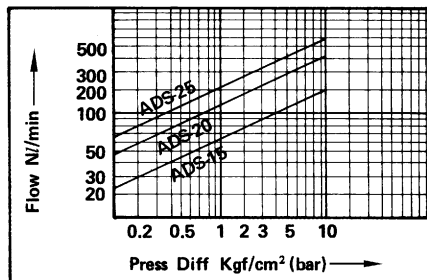

● Fluid:Liquid ADS-35.40.50(AF)

